



CRST14F

Dimensions: 29X12.6X20.6mm

Features

- 1, Slim type and small occupying area can offer high density PCB technique.
- 2, Employment of suitable plastic materials to be applied to high temperature and various chemical solution.
- 3, Relay cover switching capacity from 10A to 16A.
- 4, Switching capacity by 5A available with 2 transfer contact forms.

Ordering information

CRST14F - S - 12 10 1C L

1 2 3 4 5 6

- 1, Part number: CRST14F
- 2, Enclosure: S: Sealed type; Nil: Dust cover
- 3, Coil rated voltage(V): DC: 3, 5, 9, 12, 24, 48
- 4, Contact Current: 05: 5A; 08: 8A; 10: 10A; 16: 16A
- 5, Contact arrangement: 1A: 1A; 2A: 2A; 1C: 1C; 2C: 2C
- 6, Coil power consumption: L: 0.54W; Nil: 0.72W

Contact data

Contact Arrangement	1C; 2C;		
Contact Material	AgCdO, AgSnO ₂		
Contact Rating(Resistive)	1A,1B,1C	1A,1B,1C	2A,2B,2C
	16A/250VAC;28VDC	10A/250VAC;28VDC	5A/250VAC;28VDC
Max. Switching Power	480W	3840VA	
Max. Switching Voltage	28VDC	250VAC	Max. Switching Current:16A
Contact Resistance or Voltage Drop	≤100m Ω		
Operation Life	Electrical	10 ⁵	
	Mechanical	10 ⁷	

Coil Parameter (23°C)

Coil voltage (VDC)		Coil Resistance Ω ±10%	Pick up Voltage VDC(Max) (75% of rated voltage)	Release voltage VDC(Min) (10% of rated voltage)	Coil power consumption (W)	Operate Time (mS)	Release Time (mS)
Rated	Max						
5	6.5	46	3.75	0.50	0.54	≤15	≤8
6	7.8	67	4.50	0.60			
9	11.7	150	6.75	0.90			
12	15.6	267	9.00	1.20			
24	31.2	1067	18.0	2.40			
48	62.4	4267	36.0	4.80			
5	6.5	35	3.75	0.50	0.72		
12	15.6	200	9.0	1.2			
24	31.2	820	18.0	2.4			

Caution: 1, The use of any coil voltage less than the rated coil voltage will compromise the operation of the relay.

2, Pick up and release voltage are for test purposes only and are not be used as design criteria.

Operation condition

Insulation Resistance		100M Ω (at 500VDC)
Dielectric Strength	Between Contacts	1000VAC
	Between Contacts and Coil	5000VAC
Shock Resistance	Functional	(10g)98m/s ² (10g)
	Destructive	980m/s ² (100g)
Vibration Resistance		10~55Hz Double amplitude 1.5mm
Termination		PCB
Ambient Temperature		-30~70°C
Relative Humidity		85%RH(40°C)
Unit weight		Approx.13g

Dimensions(mm/Inch)

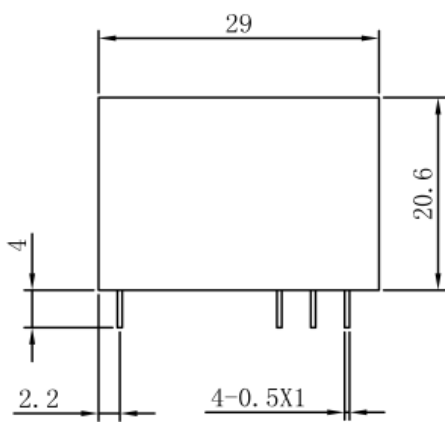

外形尺寸图
Dimensions

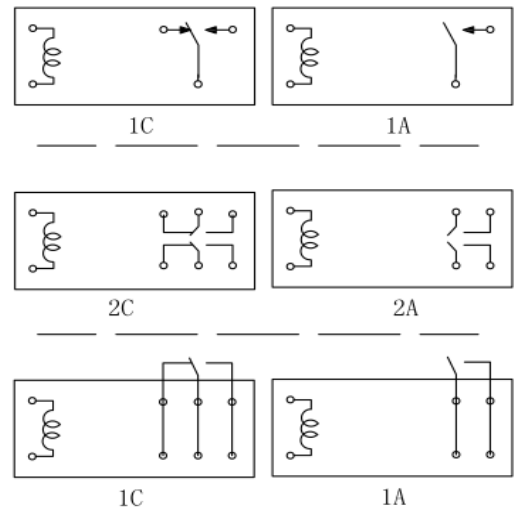

接线图
Wiring diagram

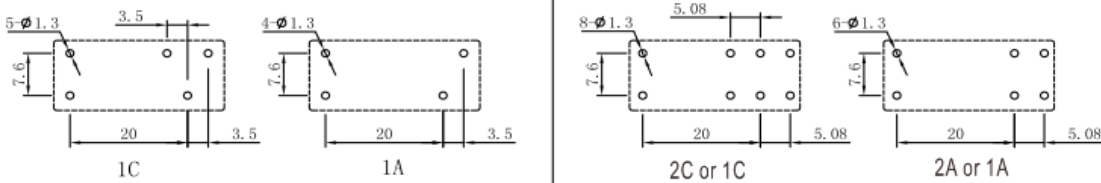

安装尺寸图
Mounting

Dimension Tolerance: < 1mm: ± 0.2 mm
 1--5mm: ± 0.3 mm
 > 5mm: ± 0.5 mm